



Shaping
creativity

EXLABESA

ARCHITECTURE

Exlabesa Building Systems Ltd.

Ogden Road - Wheatley Hills
DONCASTER DN2 4SG
Tel. +44 01302 762500 Fax + 44 01302 762557
www.exlabesa.com



QUALICOAT
ISO 9001
PAS 24:2016

Exlabesa Building Systems Ltd. prohibits total or partial reproduction of this brochure by any written means, as well as magnetic or electronic devices, without our express and written authorization.
Exlabesa Building Systems Ltd. reserves the right to modify, improve or remove without prior notice any of the products shown in this catalogue.
Exlabesa Building Systems Ltd. is not responsible for possible mistakes that may occur in this brochure and recommends verifying that the references appearing here are correct before making any order.
The material lists, modulations and discounts included in all models are illustrative and it is the customers responsibility to carry out the pertinent checks before proceeding with an order.

Extruding and shaping your world

At Exlabesa we want to make aluminium a solution that allows the world to have the shape it needs, discovering new ways for architecture, making the impossible possible.

We make true the needs, dreams and aspirations of those around us. Inspiring new possibilities, extruding and giving impossible shapes to aluminium, with the capacity of a giant and the precision of those who take care of the details, to help you get where nobody has arrived before.

We design, research, extrude and manufacture the perfect solution to help you in making everything you can imagine possible, with the conviction, experience and certainty of making it happen. Thanks to our experience, inimitable production capabilities, state-of-the-art technology and the best talent in the industry ready to make possible the impossible.

EXLABESA SYSTEMS

Casement windows
Tilt & Turn windows
Sliding Patio doors
Bi-folding doors

Residential doors
Curtain walling
Shopfronts
Glass balustrades

You inspire the energy
that moves us,
we shape the world
that inspires you



Made in Britain

At Exlabesa we want to make true the needs, dreams and aspirations of those around us. We always strive to ensure that all customers receive high quality and easy to fabricate aluminium systems with quick lead-times and a fully personalised service.



GLOBAL COMPANY

We are an aluminium systems house committed to offering products 100% adapted to meet British industry standards.



SERVICE

We can deliver high performing aluminium systems to glazing fabricators across the UK thanks to our complete distribution network.



QUALITY

Our aluminium systems are technically adapted and tested to meet the British industry standards, ensuring our customers always receive quality aluminium products and best possible performance. Most of our systems have PAS-24 accreditation, so offer reassuring security as well as meeting the requirements of Document Q of Building regulations.



LOCAL PRODUCTION

All Exlabesa UK products are manufactured at our 9-acre factory based in Doncaster – South Yorkshire equipped with 2 state-of-the-art extrusion lines, 1 vertical paint line (Qualicoat approved), 1 anodising plant, 1 polyamide assembly line, 1 CNC and a large profile & accessories stockage area. We guarantee a product specially developed to satisfy the local requirements.



FABRICATOR FRIENDLY SYSTEMS

Thanks to the compatibility of both sections and accessories across the ranges our customers can manage low stock levels. The smart design of our systems allows also an easy and quick fabrication.

Enhancing your ideas

Exlabesa Support Hub



Shaping your projects.

Every project has its own nature, that is why our experienced team of engineers are always keen to help you get the best performance and results for your building projects.

We put our knowledge, capabilities and ingenuity at your disposal.

In order to meet your design specifications and your project requirements, we support you along the decision process to make whatever you have imagined into a reality by choosing our aluminium window, door or curtain walling system that best suits your project, always with the utmost guarantee and technical support excellence.



©Antonio Navarro Wijkmark

Tailored services

- U-value calculations
- Inertia calculations
- Profile dimensioning
- Estimations
- Logikal software training

Technical documentation

- Product catalogues
- Fabrication manuals
- CAD sections
- PAS-24 test certificates
- Weather test certificates

Borders? They don't exist

Exlabesa Global

We break down borders by bringing projects to life anywhere in the world.

At Exlabesa we were born to enhance the use of respectful, sustainable and circular solutions in the aluminium industry, boosting economies and local systems, generating employment, developing the industry and creating new opportunities for everyone.

We break down borders by bringing projects to life anywhere in the world. We give shape to your creativity using state-of-the-art technology, engineering solutions that exceeds industry standards and bringing added value to the entire production chain thanks to the expertise of an international team.

At Exlabesa we have been bringing your projects to life for over 50 years thanks to our knowledge on aluminium and our extraordinary production capabilities, distributed throughout 9 production plants and 20 work centres across 3 continents.

We have production centres in the UK, Germany, Spain, Poland, Portugal, Morocco and the USA and sales presence in over 40 countries, allowing us to put an international network of aluminium systems experts at your disposal.

1966	Exlabesa Spain Valga	2008	Exlabesa Poland Tułowice
1992	Exlabesa Spain Picaraña and Rois	2011	Exlabesa United States Tifton
2001	Exlabesa United Kingdom Doncaster	2016	Exlabesa Weseralu Germany Minden
2007	Exlabesa Morocco Tanger	2022	Exlabesa Portugal Coimbra

Massive. Beautiful.
Efficient.



Capabilities born from your needs

Capabilities

We develop all our aluminium systems paying special attention to every detail of the manufacturing process from the design to the end of its useful life. To do so, we complete the entire aluminium production process to make anything you have imagined a reality while respecting the environment we live in.

We have unique capabilities that allow us to make the extrusion, painting, anodising, cutting, machining and polyamide assembly, as well as the packaging, delivery of the completely finished profiles and their subsequent recycling.

At Exlabesa, we have the experience, knowledge and technology necessary to bring anything you can imagine to life through aluminium.

27

EXTRUSION
PRESSES

9

PAINT
PLANTS

11

POLYAMIDE
ASSEMBLY LINES

30

MACHINING
CENTRES

5

ANODISING
PLANTS

2

BENDING
CENTRES

1

RECYCLING
PLANT



210 000 m²
OF FACTORY

220 000 Tm/year
EXTRUSION CAPACITY

160 000 Tm/year
EXTRUDED ALUMINIUM



15 000
CUSTOMERS

1800
EMPLOYEES

20
WORK CENTRES



40
COUNTRIES

9
PRODUCTION CENTRES

3
CONTINENTS

Impossible? Not for us

Facts & Figures

**We are a reliable,
trustworthy and
competitive company.**

Our ambition and your trust have been essential in reaching this point, which is why we continue to work with the same commitment as we did 50 years ago to take aluminium wherever you need it.

We continue to do so by investing in improving our equipment, our processes and our production and technological capabilities, while always looking to the future.

Designing tomorrow

Quality

+50
YEARS
OF EXPERIENCE

More than 50 years of experience.

Thanks to our know-how and skills, we are capable not only of meeting current regulations, but also exceed them, making our aluminium systems the best option for all kind of building projects. We test our systems according to PAS-24 and we develop them to meet the requirements of Document Q of Building Regulations.



We improve continuously our process and products.

At Exlabesa we are certified by the ISO 9001 (Quality Management System) and the ISO 18001 (Health & Safety) to ensure that we have an effective organisation that allow us to meet the goals as well as guaranteeing that our team members are in an environment that facilitate their performance.



We guarantee the traceability of our raw materials.

We manufacture our aluminium systems using high quality materials. We control the chemical composition of our alloys and we do metallographic resistance testing on our profiles, accessories and hardware, among other tests. Besides we carry out along the manufacturing process quality controls using the most advanced technology.

QUALICOAT

QUALIDECO

QUALANOD

ISO 9001

ISO 14001

ISO 45001



Your goals? Our horizon

Logistics

We guarantee our customers the best service.

Our comprehensive logistics network couple with our large fleet of lorries give high added value to our systems. Furthermore, to guarantee and immediate supply of our profiles, accessories and hardware, we have a stock ready to suit your needs.

In addition to our logistical capacity, our industrial capacity means we can complete the entire aluminium production process under one roof allowing us to reduce delivery times to the absolute minimum.

Profiling innovation

Research & Development

At Exlabesa we engineer all our aluminium systems with the goal of meeting the building standards and technical demands of today's architecture.

The determination of R&D team allows us to improve our systems during the product design process, thus achieving excellent U-values and weather performance.

Our R&D centre operates a state-of-the-art weather test rig with capacity up to four meters high and wide, for testing our windows & doors systems for air permeability, watertightness and wind resistance. We also use innovative software to calculate U-values and acoustic isolation.



Our sights are firmly fixed on the future.

Exlabesa is at the forefront of the industry, investing in state-of-the-art technology that allows us to develop architectural aluminium systems practically without boundaries, making the impossible possible.



We bring your ideas to life.

Our **team of engineers** explores the infinite possibilities of aluminium with modern test laboratories, calculation software, 3D printing and CAD & 3D modelling, to precisely meet your needs.

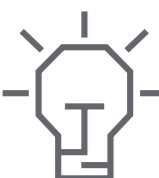

Massive creativity.

We are a source of inspiration, opening new worlds to dream about and making the most technical solutions merge with the aesthetic world.

We take your creativity
to the impossible by
betting on engineering
and the avant-garde

Index of systems

19	Casement windows
20	KC51
22	KC75
24	KS59
27	Tilt & Turn window
28	KT51
31	Sliding doors
32	KLS
34	Xlaslide
37	Bi-folding door
38	Xlafold
41	Residential door
42	KD51
45	Curtain walling
46	ECW-50
48	KLW
51	Shopfront
52	KTS
54	KSF
57	Glass balustrade
58	Glass Rail

Exlabesa Building Systems Ltd.

Ogden Road - Wheatley Hills
DONCASTER DN2 4SG
Tel. +44 01302 762500 Fax + 44 01302 762557
www.exlabesa.com



EXLABESA
ARCHITECTURE

Casement windows

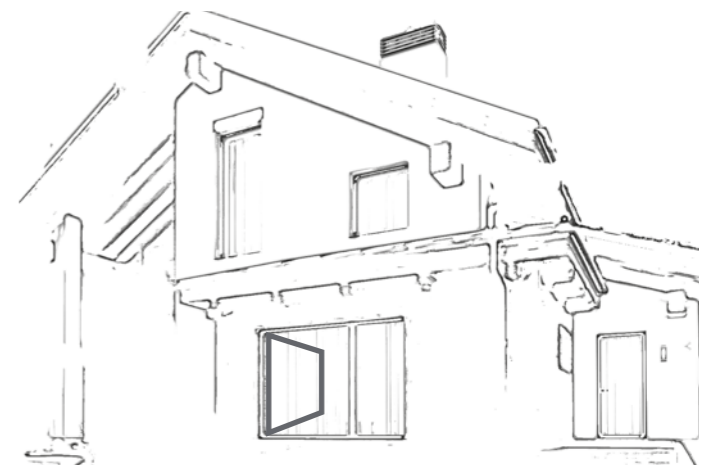

Exlabesa Building Systems Ltd.

Ogden Road - Wheatley Hills
DONCASTER DN2 4SG
Tel. +44 01302 762500 Fax + 44 01302 762557
www.exlabesa.com



QUALICOAT
ISO 9001
PAS 24:2016

EXLABESA
ARCHITECTURE

KC51

Casement window.

Innovation and aesthetics united in a single system. KC51 Casement window mixes a modern and contemporary appearance with optimal technical features, especially its safety and energy saving benefits.



Features

- PAS 24 tested
- Top and side hung applications
- 24 mm polyamides
- 4 to 33 mm glass options available
- Joined using mechanical corner cleats
- 75 mm polyamide sub frame section, for easy to install modular windows
- Egress options as standard
- Cills, add ons, curtain walling insert and coupler sections available
- Reverse adaptors for interior/exterior glazing



Maximum size	1500x1500 mm top hung 900x1500 mm side hung
Maximum weight	50 kg
Maximum glazing	32,8 mm
Polyamide	24 mm
U _w value	1,5 W/m²K

Air/Water/Wind tests according to standard BS6375-1

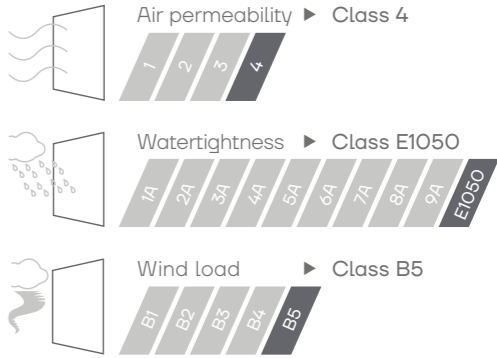

✓ PAS 24 Security ✓ BS6375-2 ✓ BS6375-3

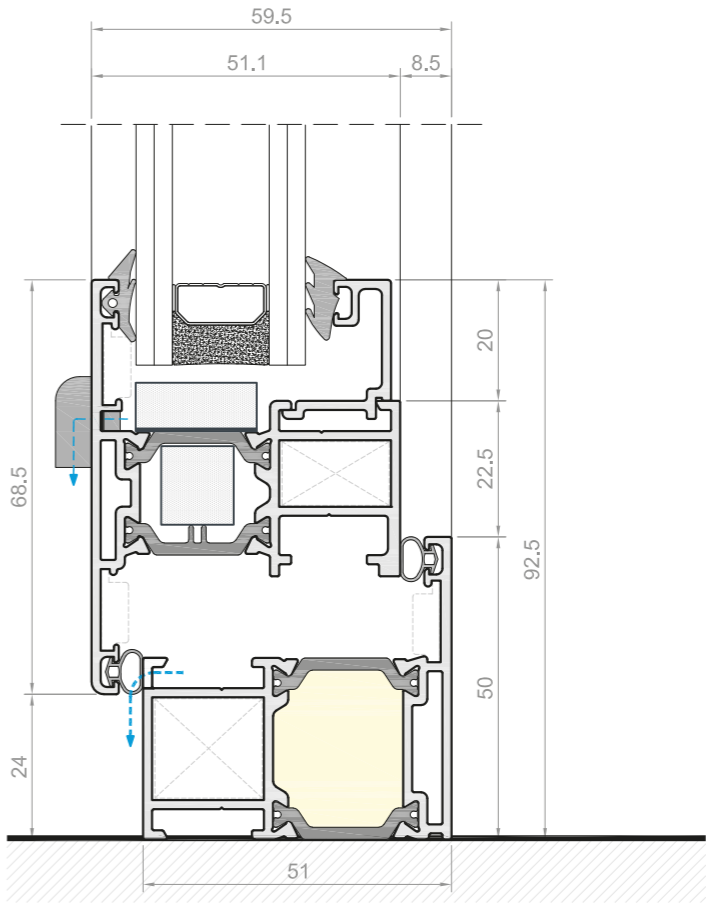

TYPICAL CONFIGURATIONS

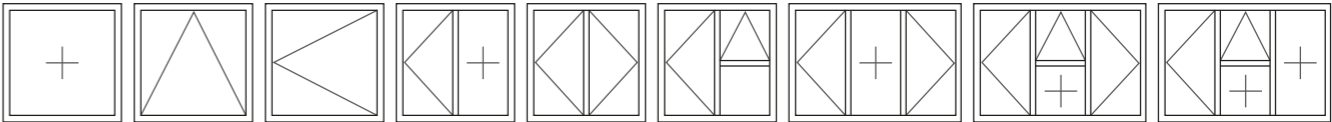

KC75

Casement window.

Aluminium windows make a stunning statement in any home. KC75 aluminium windows have slim frames that maximise the amount of natural light, making them perfect for both traditional and modern homes.

With a choice of design options, this system comes with a multitude of practical features for today's modern day living, while exceeding the energy performance requirements of current Part L Building Regulations.



Maximum size	1500x1500 mm top hung 900x1500 mm side hung
Maximum weight	50 kg
Maximum glazing	56 mm
Polyamide	32 mm
U _w value	1,2 W/m²K

Air/Water/Wind tests according to standard BS6375-1

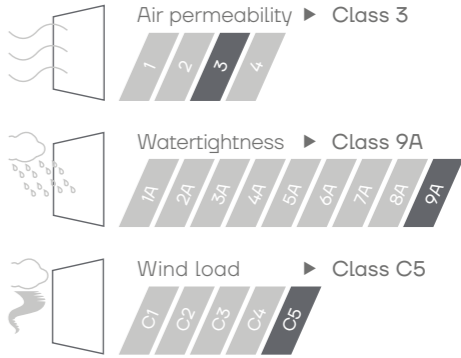

✓ PAS 24 Security ✓ BS6375-2

Features

- PAS 24 tested
- Top and side hung applications
- Joined using mechanical corner cleats
- 75 mm polyamide sub frame section, for easy to install modular windows
- Egress option available
- Slimline internal glazing option
- Cills, add ons, curtain walling insert & coupler sections available
- Flush sash option available

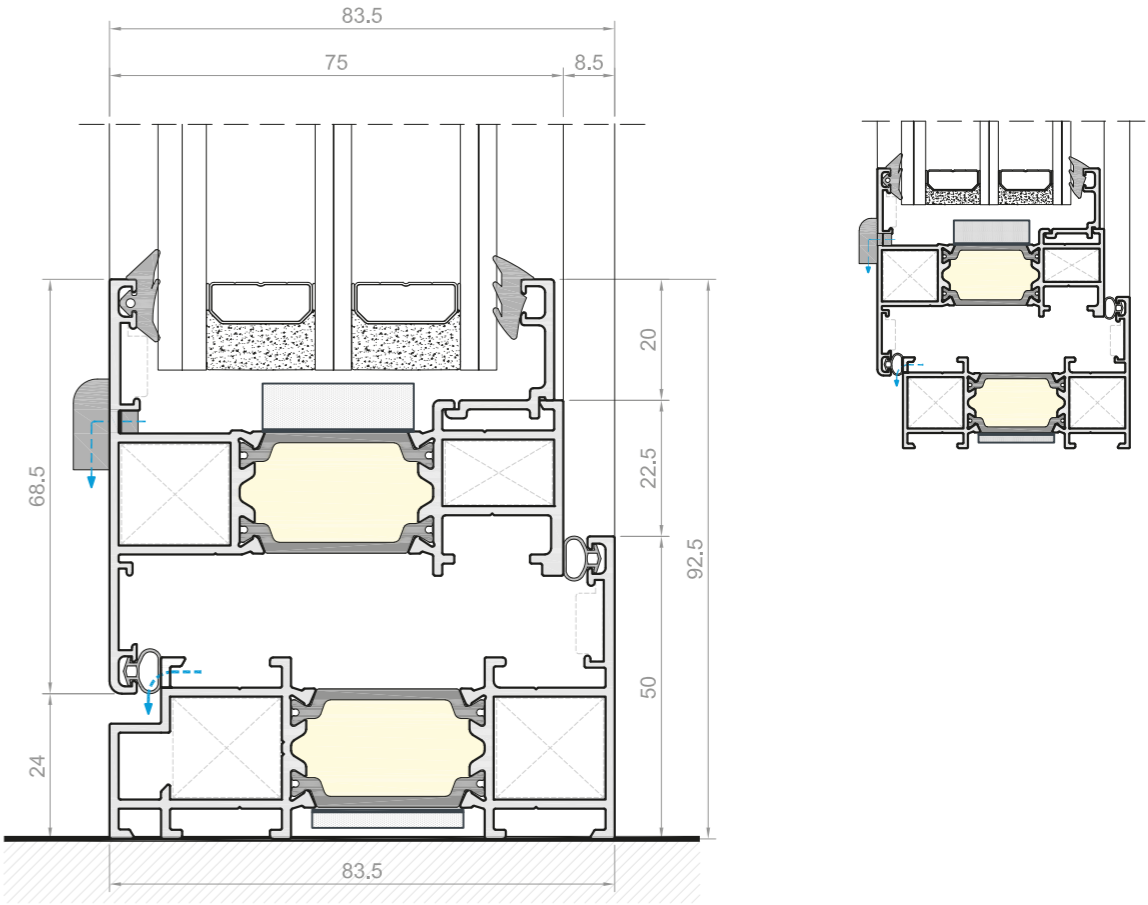

TYPICAL CONFIGURATIONS

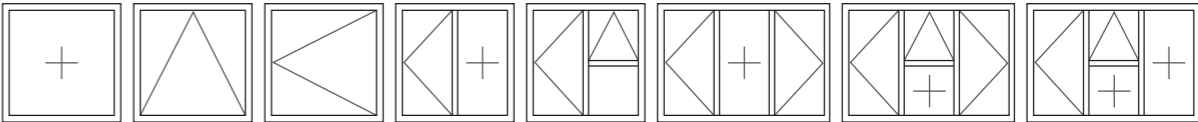

KS59

Casement window.

A modern design that maximizes the glazed area is a must in any window system. **KS59** Steel lookalike casement window is designed to mimic steel windows. This open out window system unites performance and practicality to give a contemporary look where slim sightlines and profiled sections stand out, making it an ideal choice for both refurbishments and new builds.



Maximum size	1200x1500 mm top hung 600x1200 mm side hung
Maximum weight	50 kg
Maximum glazing	28 mm
Polyamide	24/32 mm
U _w value	1,4 W/m²K

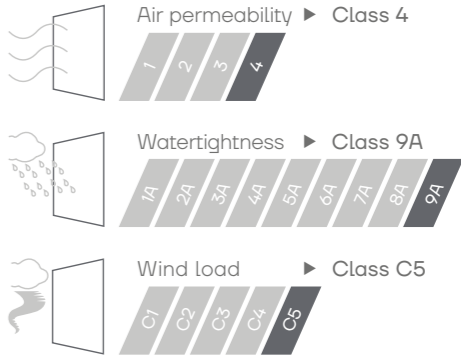

Air/Water/Wind tests according to standard BS6375-1



Features

- Top and side hung applications
- 32 mm polyamide
- 28 mm glass, as standard
- Joined using mechanical corner cleats
- Egress options available
- Cills, add ons and coupler sections available

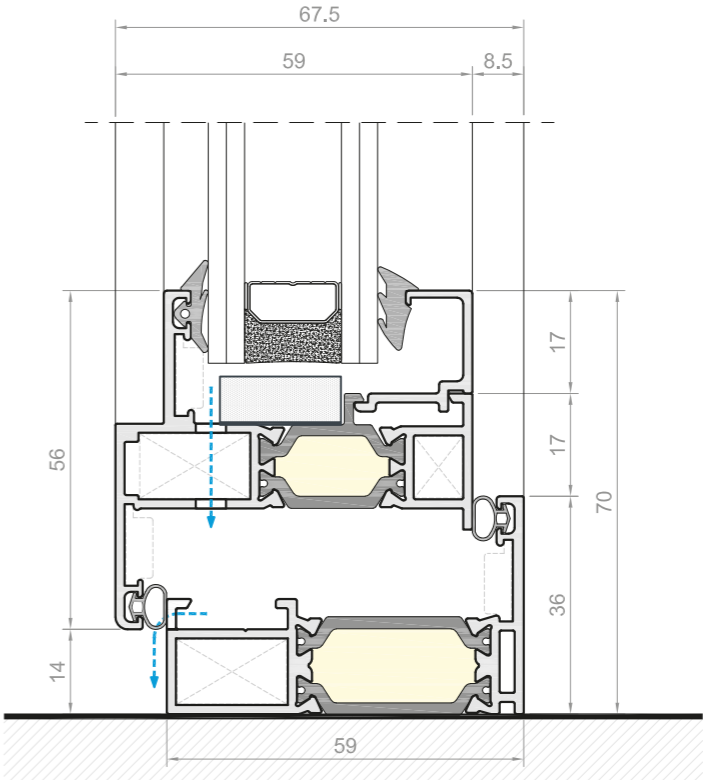

TYPICAL CONFIGURATIONS

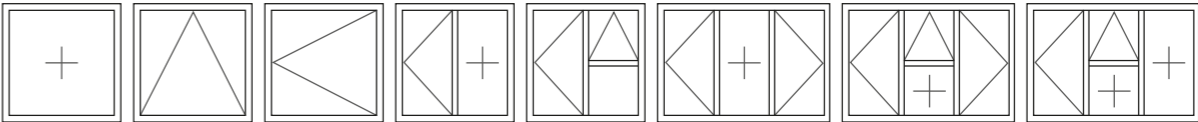

Tilt & Turn window



Exlabesa Building Systems Ltd.

Ogden Road - Wheatley Hills
DONCASTER DN2 4SG
Tel. +44 01302 762500 Fax + 44 01302 762557
www.exlabesa.com



EXLABESA
ARCHITECTURE

KT51

Tilt & Turn window.

A system capable of adapting to the aesthetic and functional needs of any building is essential in architecture. **KT51** Tilt & Turn offers a huge range of adaptable options for any room, thanks to the combination of its opening possibilities. Furthermore, its technical features are excellent, making this system one of the most complete in our range.



Features

- Top and side hung applications, as well as Tilt & Turn
- 32 mm polyamide
- 28 mm glass, as standard
- Joined using mechanical corner cleats
- Egress options available
- Cills, add ons, curtain walling insert and coupler sections available



Maximum leaf size	1500x2100 mm
Maximum weight	90 kg
Maximum glazing	32,8 mm
Polyamide	24/32 mm
U _w value	1,4 W/m²K

Air/Water/Wind tests according to standard BS6375-1

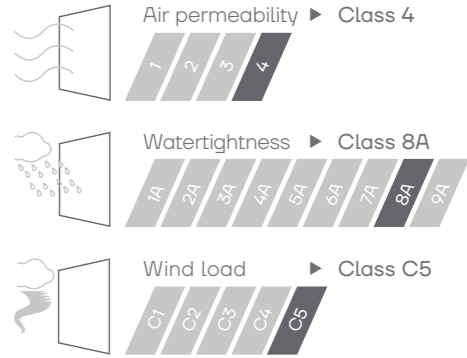

✓ PAS 24 Security ✓ BS7950 Security ✓ BS6375-2

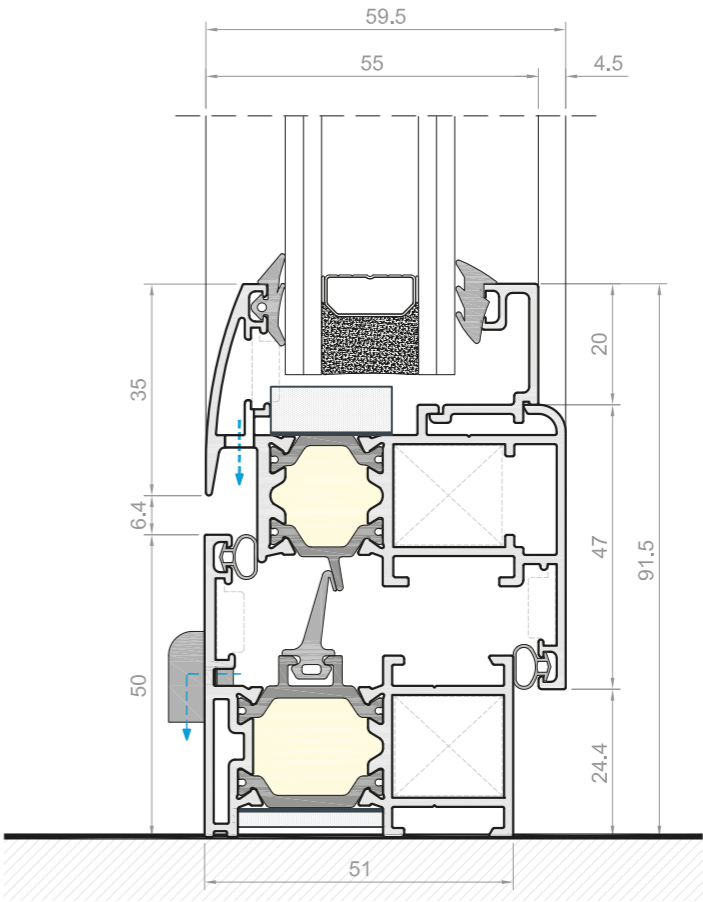

TYPICAL CONFIGURATIONS

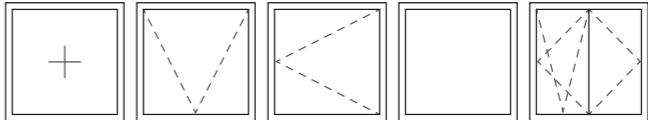

Sliding doors



Exlabesa Building Systems Ltd.

Ogden Road - Wheatley Hills
DONCASTER DN2 4SG
Tel. +44 01302 762500 Fax + 44 01302 762557
www.exlabesa.com



KLS

Lift & Slide patio door.

KLS aluminium patio doors offers a full width clear opening to your terrace and garden. With the trend for large expanses of glass that give unrestricted views to the outside, the patio door delivers this better than any other type of door on the market.

Viewed from inside or outside, the KLS aluminium patio door will transform the look of your room as well as your home.



Features

- Mechanical corner joint for ease of fabrication
- Variation of glass thickness' available
- Doors up to 400 kg available
- Outstandingly smooth & quiet sash movement
- Internally beaded for security
- Hardware designed to ensure ease of use



Maximum leaf size	3300x3200 mm
Maximum weight	400 kg lift & slide 220 kg slide only
Maximum glazing	39,5 mm
Polyamide	24 mm
U _w value	1,4 W/m²K

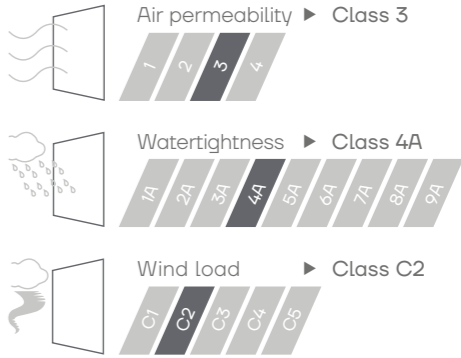

Air/Water/Wind tests according to standard Weather (EU test)

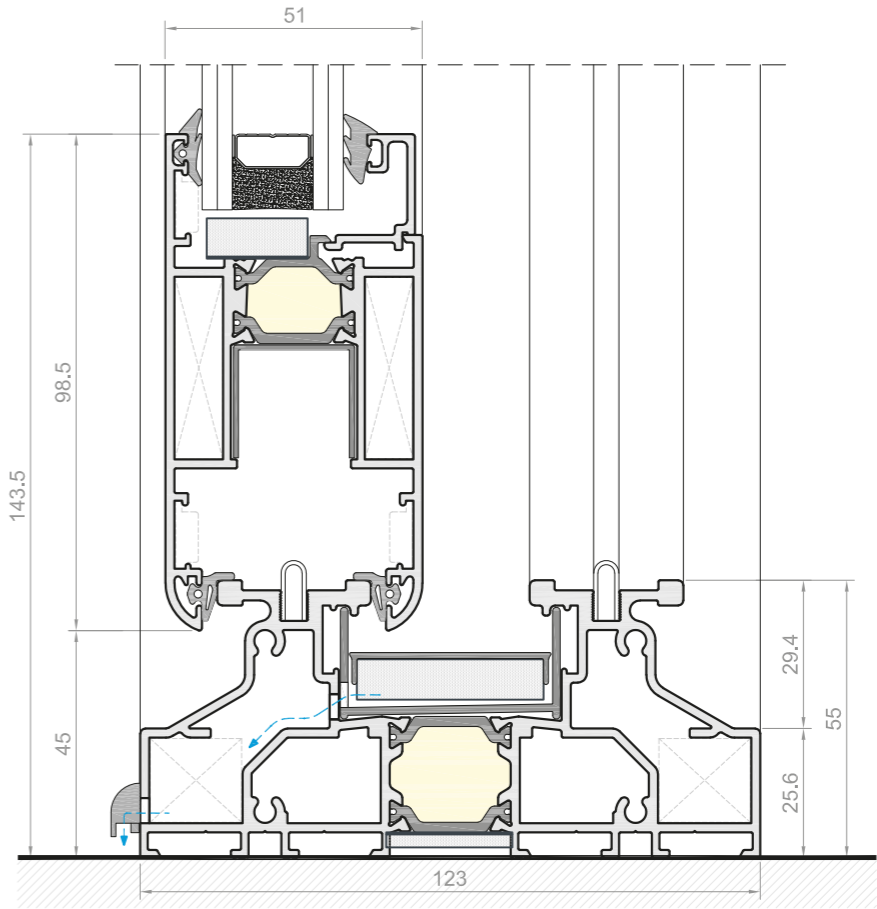

TYPICAL CONFIGURATIONS

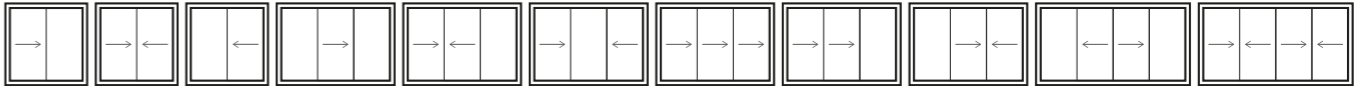

Xlaslide

Sliding patio door.

Connecting the internal and external space, giving significance to glass is a trend in architecture. Xlaslide patio door, with its modern design focused on its slim sightlines, provides an extraordinary connection with the outside, maximizing the sunlight entry into the room.



Maximum leaf size	2430x2500 mm
Maximum weight	200 kg
Maximum glazing	36 mm
Polyamide	24 mm
U _w value	1,2 W/m²K

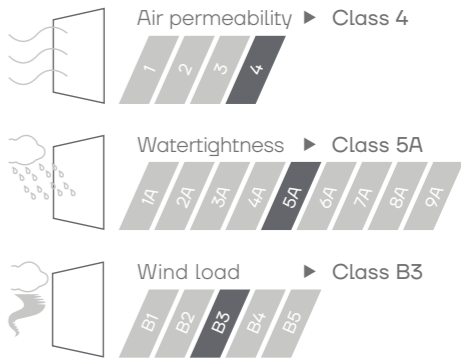

Air/Water/Wind tests according to standard BS6375-1



Features

- Mechanical corner joint for ease of fabrication
- Slim 32 mm interlock available
- Slim sightlines
- Twin & Triple track options
- Internally beaded for security
- Doors up to 200 kg available

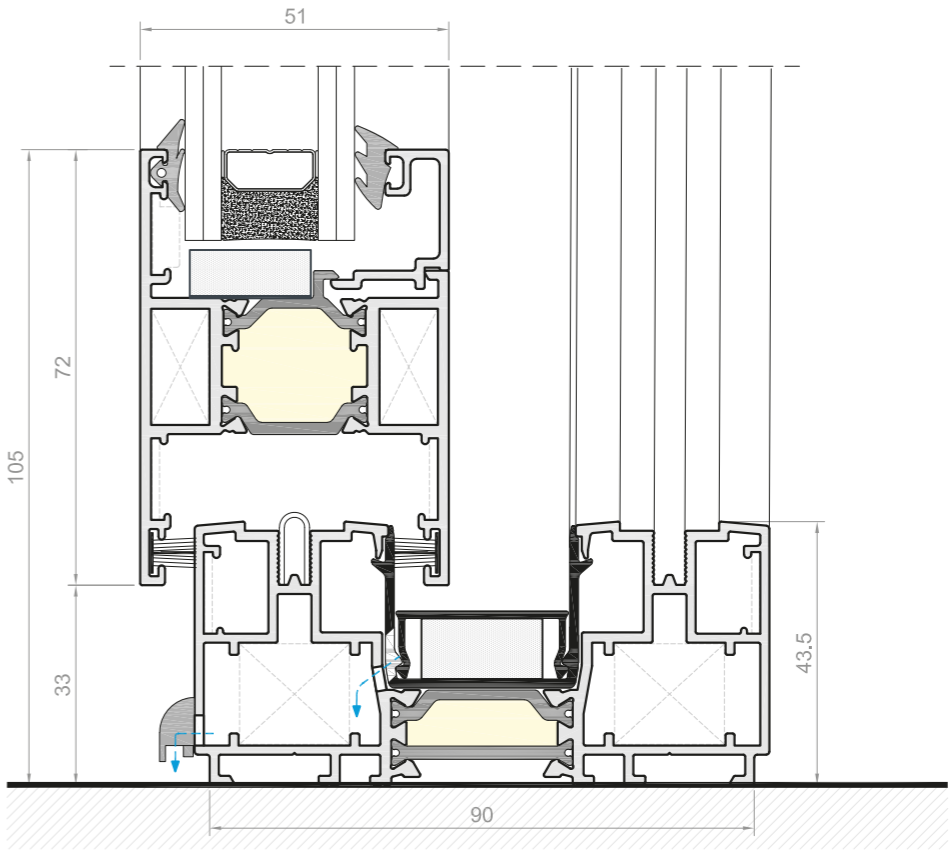

TYPICAL CONFIGURATIONS

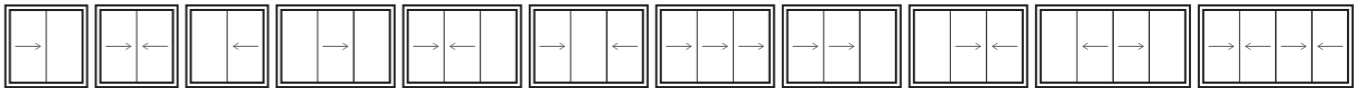

Bi-folding door



Exlabesa Building Systems Ltd.

Ogden Road - Wheatley Hills
DONCASTER DN2 4SG
Tel. +44 01302 762500 Fax + 44 01302 762557
www.exlabesa.com



QUALICOAT
ISO 9001
PAS 24:2016

EXLABESA
ARCHITECTURE

Xlafold

Bi-folding door.

Nothing beats the feel-good factor of an open living space. A seamless transition to outdoor living, Xlafold aluminium bi-folding doors offer superb slimline aesthetics with a strong, robust performance. This system maximises the glazed area thanks to their sleek, slimline aluminium profiles which deliver maximum light appeal.



Maximum leaf size	1000x2400 mm
Maximum weight	100 kg
Maximum glazing	40 mm
Polyamide	20/32 mm
U _w value	1,2 W/m²K

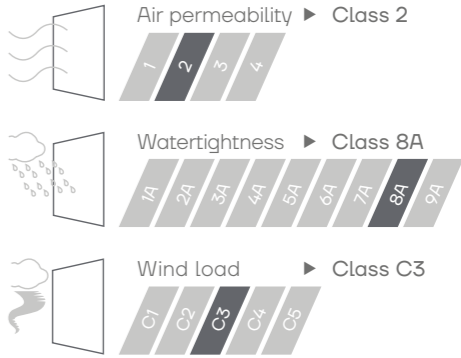

Air/Water/Wind tests according to standard BS6375-1

PAS 24 Security

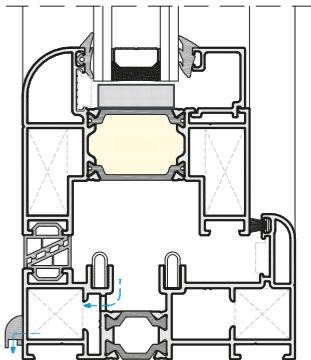
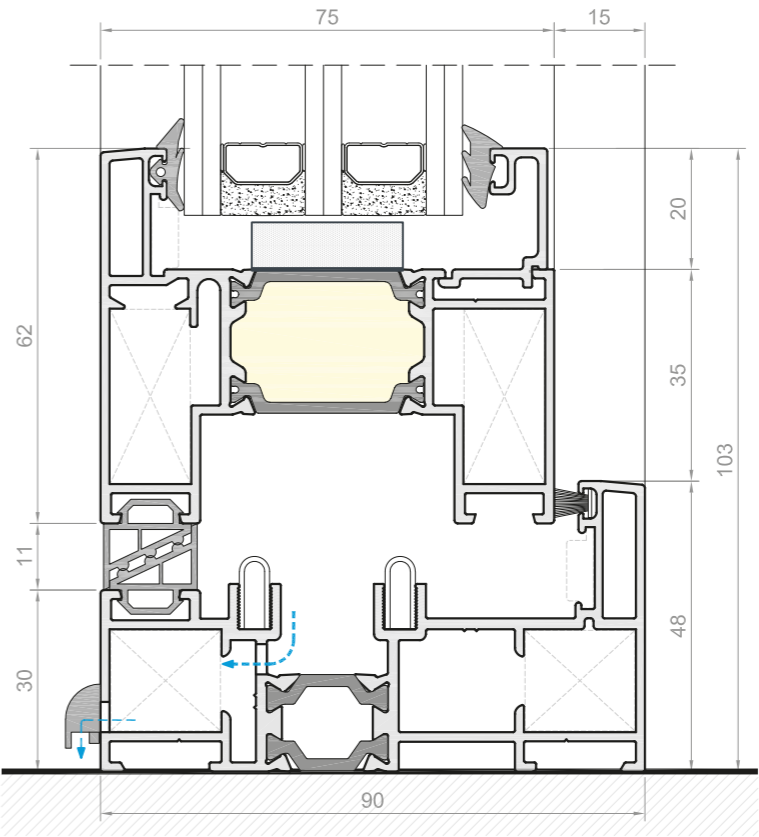

TYPICAL CONFIGURATIONS

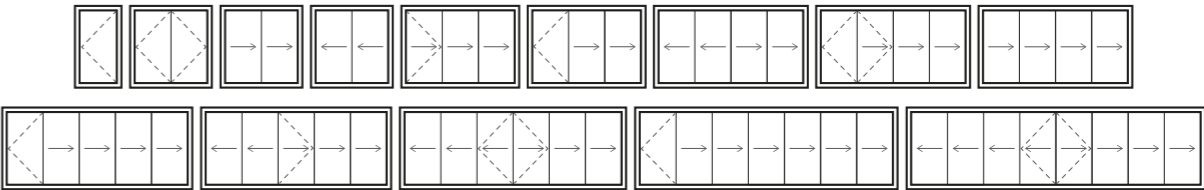

Features

- Range of configurations available
- Half rollers available for even panel number configurations
- Choice of glazing thickness' available
- Square or curved sash and outer frame options
- Square or bevelled beads
- Internally beaded for security
- Open in and open outdoors available
- “Master” doors with 3 point locking available
- French door opening configuration available

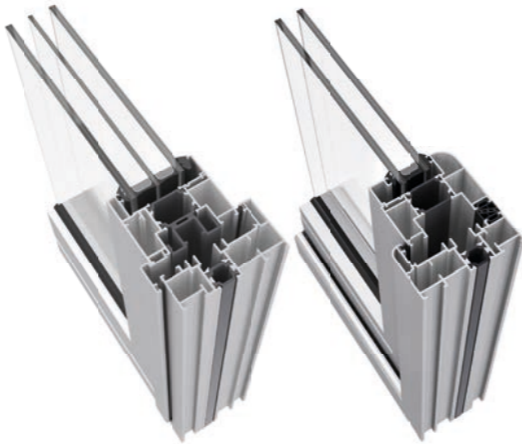

Residential door



Exlabesa Building Systems Ltd.

Ogden Road - Wheatley Hills
DONCASTER DN2 4SG
Tel. +44 01302 762500 Fax + 44 01302 762557
www.exlabesa.com



EXLABESA
ARCHITECTURE

KD51

Residential door.

Make an entrance to your home with a KD51 aluminium entrance door. Our aluminium rebated thermal doors create a beautiful entrance to match the style of your home perfectly.

Aluminium doors offer strength and durability and are highly resistant to corrosion for years of trouble-free use and operation. The natural strength of aluminium gives you beautiful sleek lines, less frame and more glass area.



Maximum sash size	1100x2400 mm
Maximum weight	50 kg
Maximum glazing	32,8 mm
Polyamide	19 mm
U _w value	1,5 W/m²K

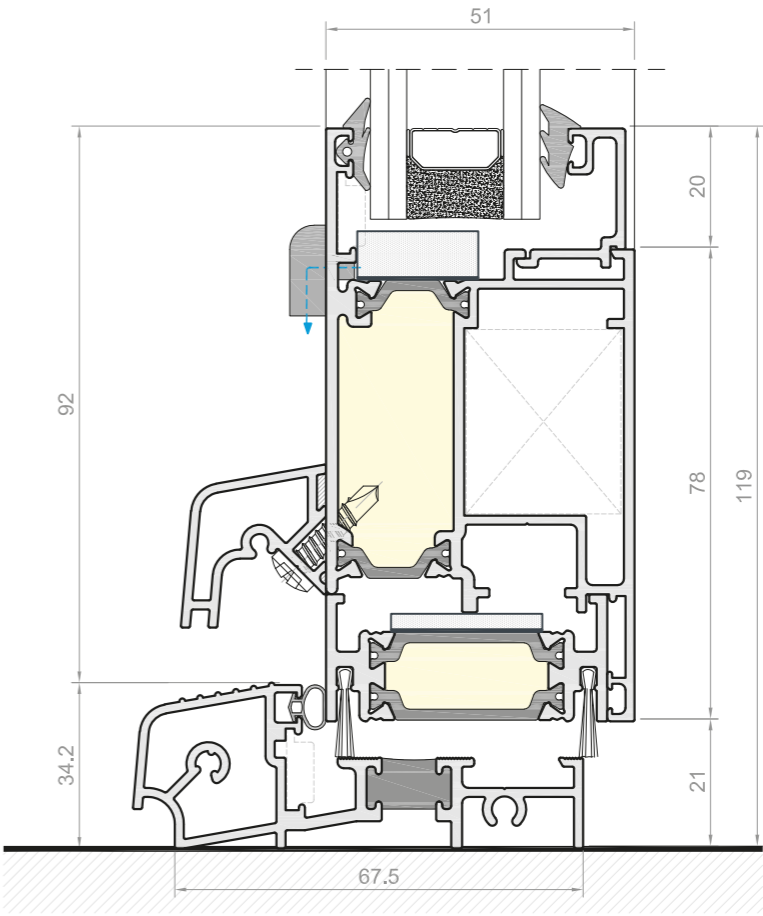

TYPICAL CONFIGURATIONS

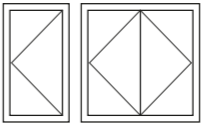

- Features
- Inward & outward open application available
 - 28 mm glass as standard as well as a wide variety of other options
 - Joined using mechanical corner cleats
 - 75 mm polyamide sub frame section for easy to install modular doors
 - Doors easily integrated with EBS window systems
 - Cills, add ons, curtain walling insert & coupler sections available
 - Multipoint locking available for secure doors



Curtain walling



Exlabesa Building Systems Ltd.

Ogden Road - Wheatley Hills
DONCASTER DN2 4SG
Tel. +44 01302 762500 Fax + 44 01302 762557
www.exlabesa.com



QUALICOAT
ISO 9001
PAS 24:2016

EXLABESA
ARCHITECTURE

ECW-50

Curtain walling.

Curtain walling allows a multitude of possibilities to achieve the uniqueness that all construction requires. **ECW-50** curtain walling allows the design of structures with great creativity and visual lightness with only 50 mm of front seen in the supporting structure.



Maximum weight	350 kg
Maximum glazing	46 mm
CWCT	Test cert available upon request

Features

- CWCT tested
- 50 mm curtain walling system
- Mullion sizes to 250 mm
- Transom sizes to 195 mm
- Polyamide thermal break for improved thermal efficiency
- Glazing to 46 mm
- Window & door insert available
- Internal reinforcing bars available for bigger spans
- A range of external caps available

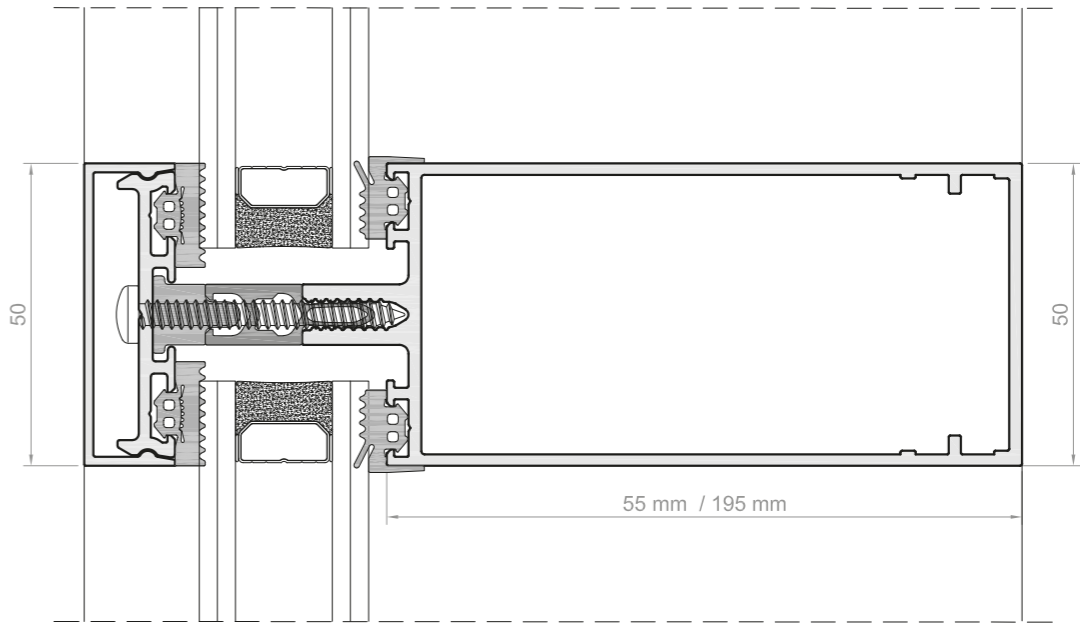

TYPICAL CONFIGURATIONS

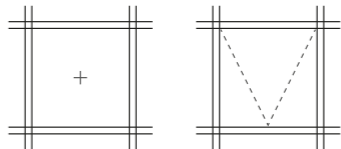

KLW

Curtain walling.

A visually slim system that maximises the glazed area, enhancing the appeal of a façade. KLW curtain walling system is only 50 mm wide, making it ideal for a huge range of projects where glass is the main point.



Maximum weight

Consult Exlabesa
technical department

Maximum glazing

34 mm

Features

- 50 mm channel & plate curtain walling system
- Transom/Mullion sizes from 50 mm to 125 mm
- Polyamide thermal break for improved thermal efficiency
- 28 mm glazing as standard
- Window & door insert available
- Faceted sections available for angled screens
- Internal reinforcing bars available for bigger spans
- A range of external caps available

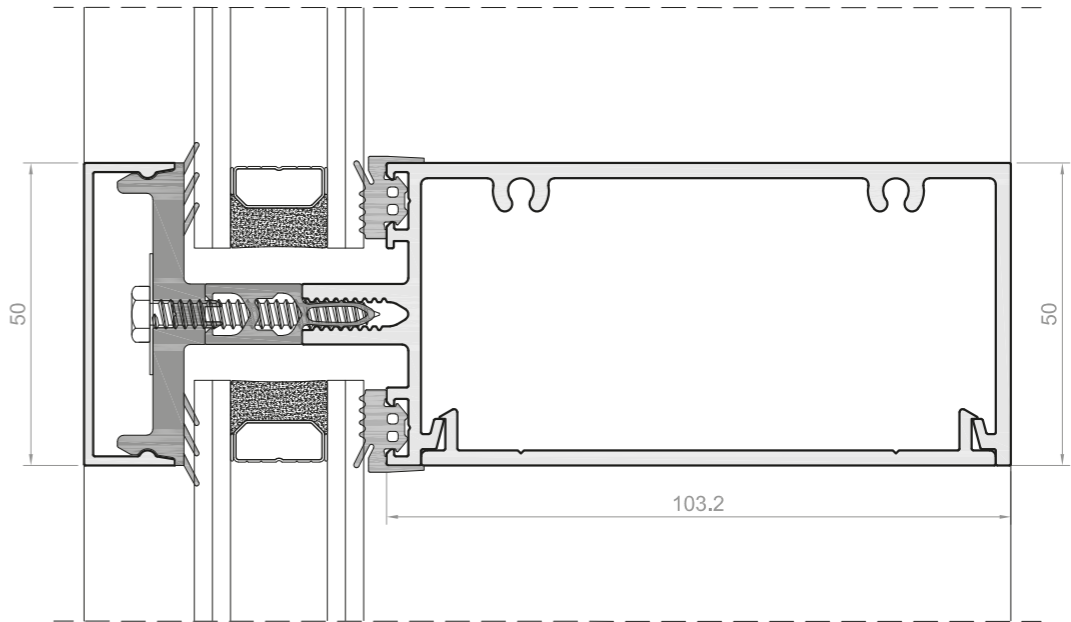

TYPICAL CONFIGURATIONS

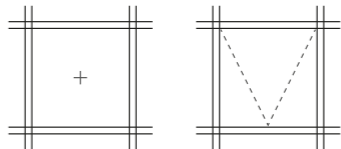

Shopfront

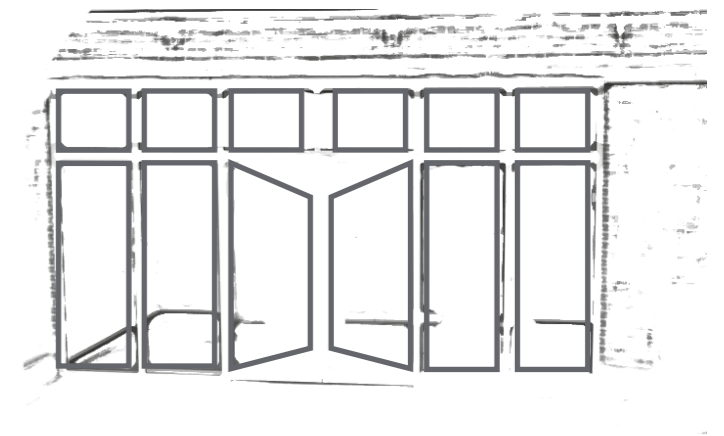

Exlabesa Building Systems Ltd.

Ogden Road - Wheatley Hills
DONCASTER DN2 4SG
Tel. +44 01302 762500 Fax + 44 01302 762557
www.exlabesa.com



EXLABESA
ARCHITECTURE

KTS

Thermal shopfront.

Security is essential when we talk about a front door. KTS Thermal shopfront is a robust system that maximizes security and ensures high thermal isolation thanks to thermal breakage. This mix makes this system an ideal choice for any kind of shopfront.



Maximum leaf size	1150x2400 mm
Maximum weight	65 kg
Maximum glazing	28,8 mm framing 32,8 mm door
Polyamide	24/32 mm
U _w value	1,4 W/m²K

✓ PAS 24 Security

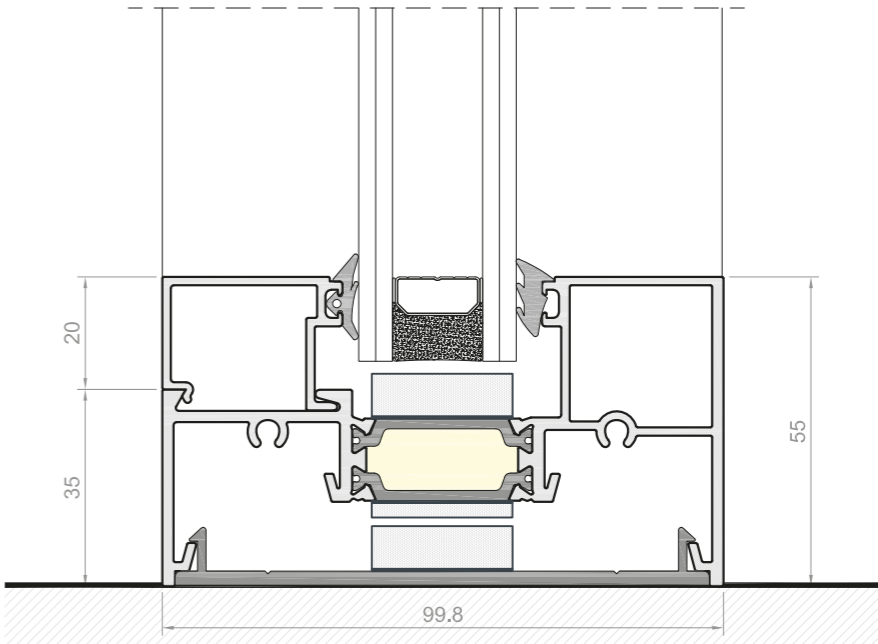

Features

- Range of shop front and door sections available
- Double glazed unit's standard throughout for improved thermal efficiency
- One section door leaf makes for a cost-effective system with little waste
- Mechanical corner joints on doors to make assembly simple
- Shop front and doors available in dual colour



TYPICAL CONFIGURATIONS

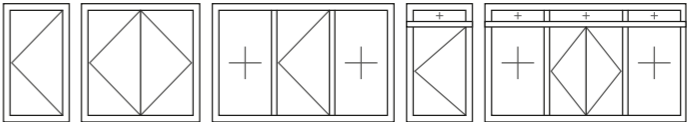

KSF

Shopfront.

A robust system designed thinking of its installation on shopfronts, **KSF** combines durability and a modern design that maximizes the glazed area with excellent value for money. This door is not only an excellent option for exteriors, it is also a good choice for interior spaces.



Maximum leaf size	1150x2400 mm
Maximum weight	65 kg
Maximum glazing	28,8 mm framing 32,8 mm door

Features

- Range of shop front & door sections available
- Double & single door profiles available
- Choice of top rails, bottom rails and a mid-rails available
- Screw port fixing for shop front sections
- Multiple glass thickness' available from 6 to 28,8 mm double glazing
- Internally beaded for increased security
- Sections available for use with auto gearing as well as manual pivot

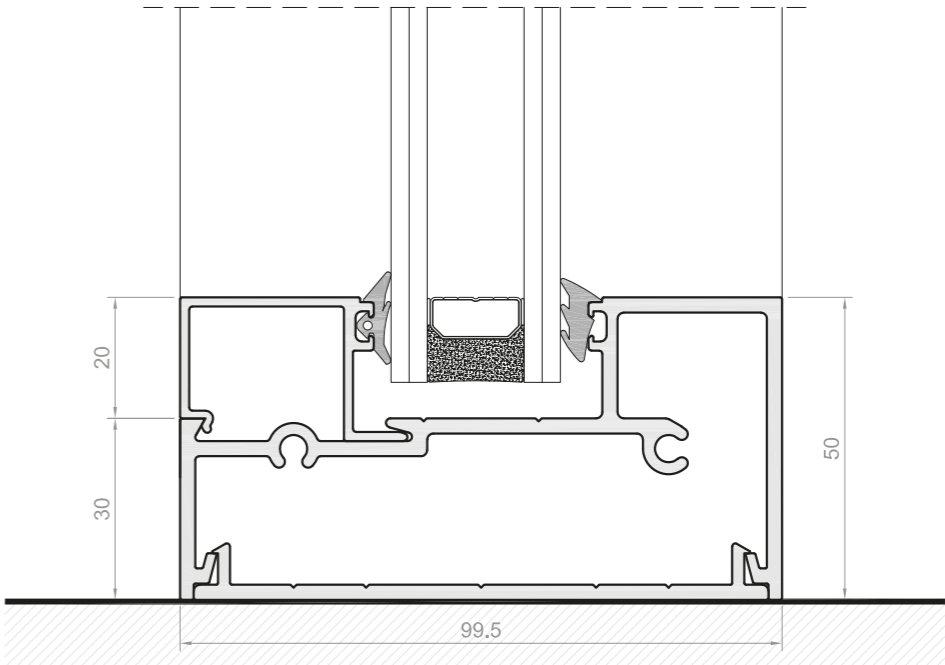

TYPICAL CONFIGURATIONS

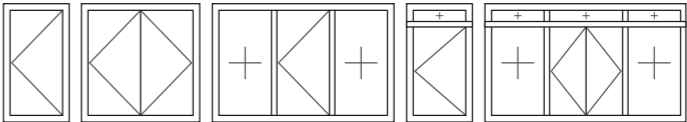

Glass balustrade

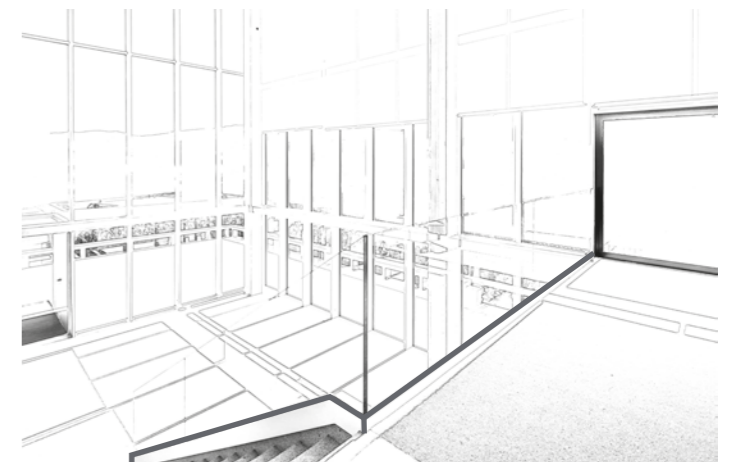

Exlabesa Building Systems Ltd.

Ogden Road - Wheatley Hills
DONCASTER DN2 4SG
Tel. +44 01302 762500 Fax + 44 01302 762557
www.exlabesa.com



QUALICOAT
ISO 9001
PAS 24:2016

EXLABESA
ARCHITECTURE

Glass Rail

Glass balustrade.

Glass Rail balustrade system has been developed to provide full safety in residential buildings with minimal visual disruption. This is a fully transparent glass balustrade system compatible with a range of terrace and staircase applications. All vertical components are totally removed to create a complete glass wall effect.



Maximum height	1100 mm
Fixing options	Top U Top F Side U Side Y
Loads (Approved to BS-6180)	0,74 to 1,5 kN/m
Glass thickness	15 / 16,76 / 17,52 / 20,76 / 21,52 mm

Features

- Base level fixing only
- Clean lines to enhance light and space
- 15 / 16.76 / 17.52 / 20.76 / 21.52 mm glass thickness
- Up to 1100 mm high
- Approved to BS-6180: 0,74 to 1,5 kN/m
- 4 mounting options available Top U, Top F, Side U and Side Y
- Wide range of colours available
- Silver anodised and mill finish bar lengths in stock

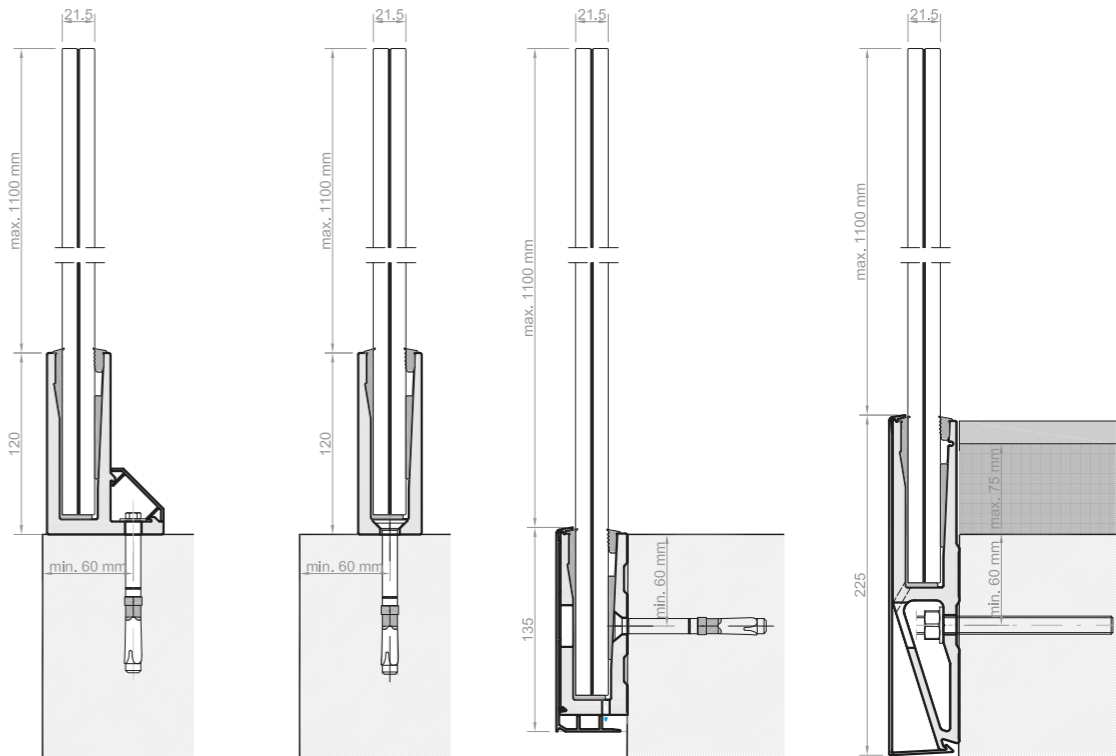

We care aluminium caring for our planet

EXLABESA CLEAN PLANET

The Exlabesa Clean Planet initiative aims to improve the environment, develop a more sustainable production system thus reducing our footprint.

We have been trusting on aluminium for more than 50 years for its excellent technical features and unmatched properties. Aluminium is 100% recyclable material without loss of quality, which positions it as one of the key materials of the present and the future, to be used in building projects.

Exlabesa owns a state-of-the-art recycling plant that allow us to manufacture recycled aluminium billets which are later used to extrude new profiles reducing significantly our footprint and energy consumption.

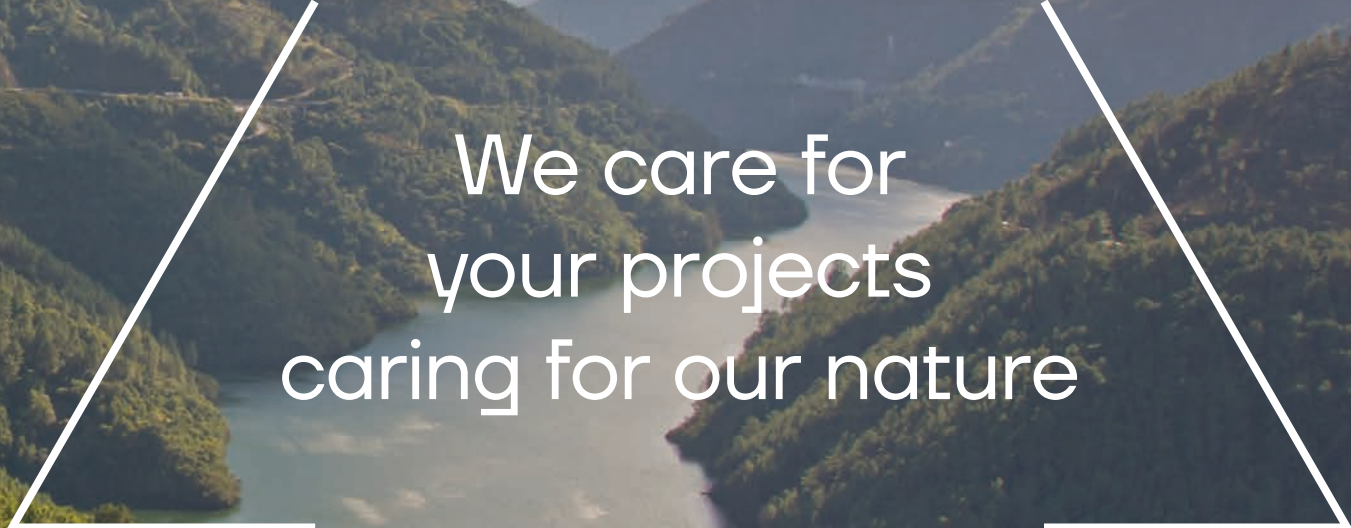

We care for
your projects
caring for our nature

Giving colour to creativity

Colours by Exlabesa

Design your projects with total creative freedom. Develop your style with our wide range of Colours by Exlabesa finishes, giving your projects a fully tailored result. We offer an unlimited range of options thanks to our technical and productive capabilities.

We want to make what you imagine come true. We look after every detail of your projects to make your wishes come true, providing the solutions that best suit your environment.

Our surface treatment offers long-term quality and durability guaranteed. The Qualicoat label guarantees the quality of our production procedures and processes, as well as the final product.

Colours by Exlabesa provides creativity and quality. The colour options in the painting range are unlimited and include options such as gloss, matt, satin and textured.

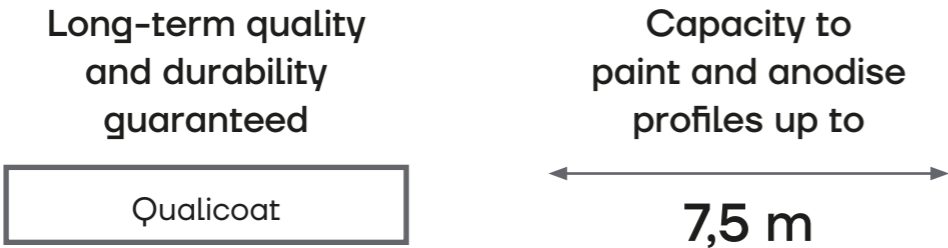

Solutions designed
by your creativity

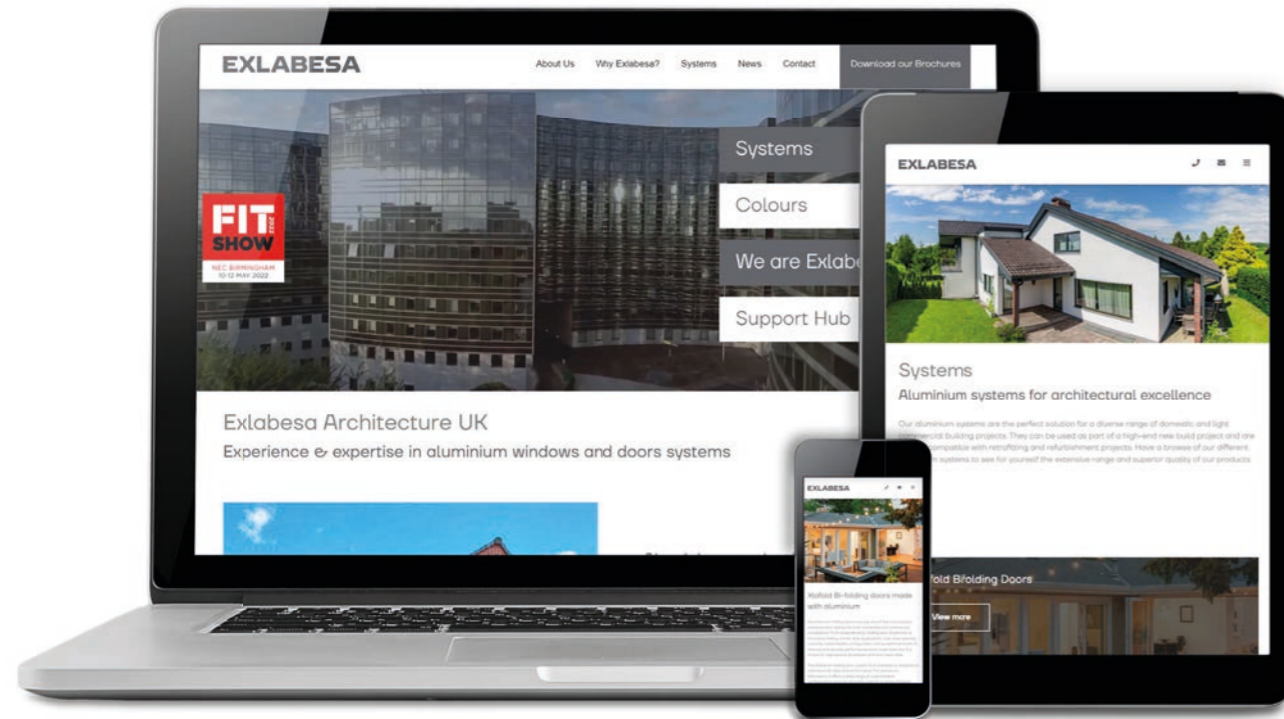

exlabesa.com

All the information at your disposal.

Information is key for the correct selection, fabrication and installation of our aluminium building systems. Therefore, at exlabesa.com we offer all kind of up-to-date technical documentation such as fabrication manuals and data sheets. You can also design your projects using our CAD sections and estimate your material requirements using our software.

Visit us at exlabesa.com and explore the infinite possibilities offered by our aluminium systems.



Exlabesa Building Systems Ltd.

Ogden Road - Wheatley Hills
DONCASTER DN2 4SG
Tel. +44 01302 762500 Fax +44 01302 762557
www.exlabesa.com

QUALICOAT | ISO 9001 | PAS 24:2016

